

Quality Enclosures

SEMI-FRAMELESS SHOWER DOOR WITH HEADER

SUPERIOR TUB ENCLOSURES
CUSTOM SHOWER DOORS

101-H WINDSOR PL, CENTRAL ISLIP, NY 11722
2025-E PORTER LAKE DR, SARASOTA, FL 34240
3348-B103 TRICKUM RD, WOODSTOCK, GA 30188

INSTALLATION INSTRUCTIONS

Tools Needed: Tape measure, hacksaw, level, power drill, $\frac{3}{16}$ carbide masonry drill bit, $\frac{7}{64}$ drill bit, phillips screw tip, rubber mallet, and silicone caulk.

Step 1: Measure distance between walls at base and cut bottom track at $\frac{1}{16}$ " less than opening.

Step 2: Place bottom track on base and set wall jambs inside bottom track along walls at center line. Plumb wall jambs with level and mark installation holes with pencil. Drill holes using $\frac{3}{16}$ bit and insert screw anchors. Secure with #8 x 1" installation screws.

Step 3: Center handle along edge of door, with rubber strip wedged in between, and knock onto glass using rubber mallet.

Step 4: Center one-piece magnet along strike jamb and cut striker seals at both ends.

Step 5: Slide hinge jamb of door and strike jamb over wall jambs. Adjust hinge jamb and strike jamb to desired positions. Drill holes along hinge jamb through wall jamb using $\frac{7}{64}$ bit and secure with #6 x $\frac{3}{8}$ " screws. Drill holes along strike jamb through wall jamb and secure with screws.

Step 6: Measure distance between walls across top of wall jambs and cut header at $\frac{1}{16}$ " less than opening. Slide over wall jambs and drill holes at header through wall jambs. Secure with #6 x $\frac{5}{8}$ " screws.

Step 7: Measure opening between hinge jamb and strike jamb. Cut threshold inserts to this dimension. Snap into bottom track and header.

Step 8: Measure from edge of door to hinge jamb and cut drip cap at $\frac{1}{8}$ " less than this dimension. Trim $\frac{1}{4}$ " off top portion (flap and legs) of drip cap on hinge side. Trim $\frac{3}{8}$ " off flap and inside leg of drip cap on strike side to ensure door will close properly. Slide drip cap onto bottom of door.

Step 9: Caulk along inside of unit where metal contacts walls and base. Outside caulking is optional.

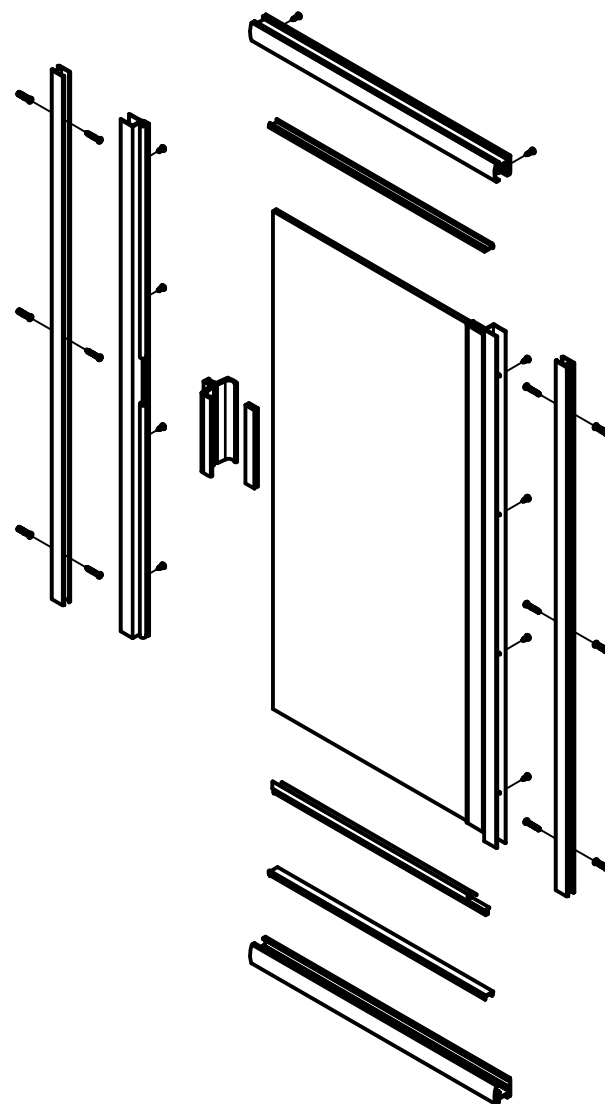

Quality
Enclosures

SEMI-FRAMELESS SHOWER DOOR WITH HEADER

SUPERIOR TUB ENCLOSURES
CUSTOM SHOWER DOORS

101-H WINDSOR PL, CENTRAL ISLIP, NY 11722
2025-E PORTER LAKE DR, SARASOTA, FL 34240
3348-B103 TRICKUM RD, WOODSTOCK, GA 30188

INSTALLATION SUPPLEMENT

