

Quality
Enclosures

SEMI-FRAMELESS NEOANGLE

SUPERIOR TUB ENCLOSURES
CUSTOM SHOWER DOORS

101-H WINDSOR PL, CENTRAL ISLIP, NY 11722
2025-E PORTER LAKE DR, SARASOTA, FL 34240
3348-B103 TRICKUM RD, WOODSTOCK, GA 30188

INSTALLATION INSTRUCTIONS

Tools Needed: Tape measure, hacksaw, level, power drill, $\frac{3}{16}$ masonry drill bit, $\frac{1}{64}$ drill bit, phillips screw tip, rubber mallet, and silicone caulk.

Step 1: Mark center lines on base. Measure left center line and cut left bottom track $\frac{1}{4}$ " more than this dimension. Do the same for right bottom track and assemble the 3-piece bottom track with supplied brackets and screws.

Step 2: Place bottom track assembly on base and set wall jambs inside bottom track along walls at center lines. Plumb wall jambs with level and mark installation holes with pencil. Drill holes using $\frac{3}{16}$ bit and insert screw anchors. Secure with #8 x 1" installation screws.

Step 3: Place 2 setting blocks inside left bottom track and set left panel on top. Slide left panel into wall jamb and secure with thin push-in vinyl on both sides. Slide corner post over left panel and set inside bottom track assembly at corner. Adjust left panel if necessary and secure with thin push-in vinyl on both sides. Do the same for right panel.

Step 4: Center handle (with rubber strip) along edge of door and knock onto glass using rubber mallet.

Step 5: Center one-piece magnet along strike jamb and cut striker seals at both ends.

Step 6: Slide hinge jamb of door over either corner post and strike jamb over other corner post. Adjust hinge jamb and strike jamb to desired positions. Drill holes along hinge jamb through 1 corner post using $\frac{1}{64}$ bit and secure with 6 x $\frac{3}{8}$ " screws. Drill holes along strike jamb through other corner post and secure with screws.

Step 7: Measure distance across top from outside corner of left corner post to left wall and cut left header $\frac{1}{16}$ " more than this dimension. Do the same for right header and assemble the 3-piece header with supplied brackets and screws.

Step 8: Slide header assembly over wall jambs and corner posts. Drill holes at header assembly through wall jambs and corner posts. Secure with #6 x $\frac{5}{8}$ " screws.

Step 9: Secure panels to header and bottom track with thick push-in vinyl on both sides.

Step 10: Measure opening between hinge jamb and strike jamb. Cut threshold inserts to this dimension. Snap into bottom track and header.

Step 11: Measure from edge of door to hinge jamb and cut drip cap at $\frac{1}{8}$ " less than this dimension. Trim $\frac{1}{4}$ " off flap and legs of drip cap on hinge side. Trim $\frac{3}{8}$ " off flap and inside leg of drip cap on strike side to ensure door will close properly on strike jamb. Slide drip cap onto bottom of door.

Step 12: Caulk along inside of unit where metal contacts walls and base. Outside caulking is optional.

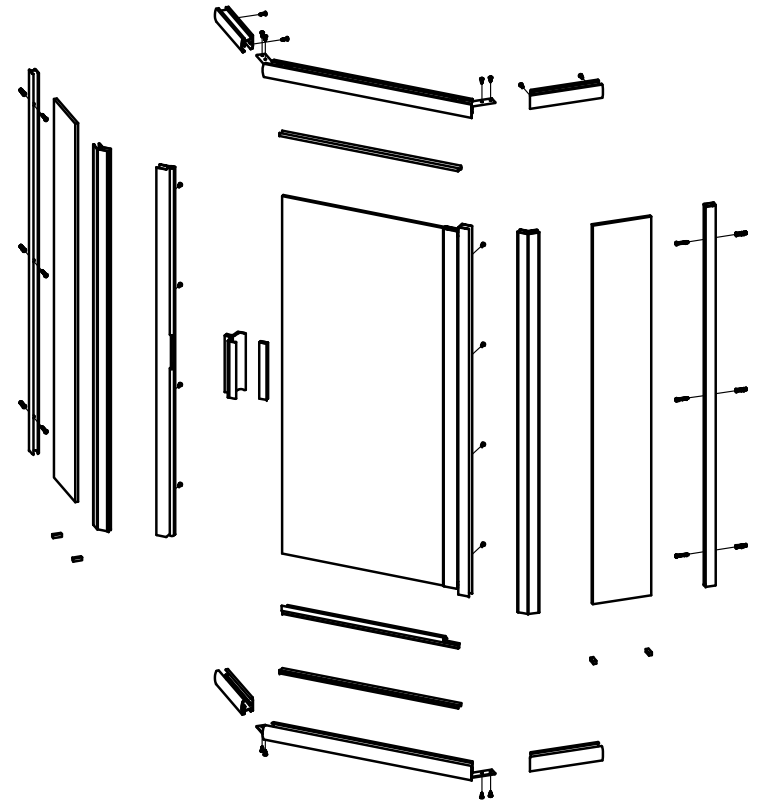

Quality
Enclosures

SEMI-FRAMELESS NEOANGLE

SUPERIOR TUB ENCLOSURES
CUSTOM SHOWER DOORS

101-H WINDSOR PL., CENTRAL ISLIP, NY 11722
2025-E PORTER LAKE DR., SARASOTA, FL 34240
3348-B103 TRICKUM RD., WOODSTOCK, GA 30188

INSTALLATION SUPPLEMENT

